

Capnography Cut-Down Masks

DESCRIPTION

Capnography offers reliable feedback about the patient's condition and how they respond to treatment, in addition to providing oxygen flow. It provides a non-invasive tool to assess ventilation by monitoring end tidal carbon dioxide (ETCO₂) through breath-to-breath analysis via the mask from the nose and mouth. Capnography is used during recovery from general anaesthesia or during sedation.

m|devices Capnography Cut-Down Mask range are adult elongated mask size and feature 3m star lumen oxygen tubing and a 10cm extension CO₂ sample line outlet. Several configurations are available in this range, with options including a 0.2micron hydrophobic filter and/or 3m CO₂ sample line.

The unique cut-down mask has been designed for use in ophthalmic surgery and any other procedures requiring further access to the face.

FEATURES & BENEFITS

- Non-invasive end tidal CO₂ monitoring
- Cut-down mask designed for use in ophthalmic surgery and procedures requiring improved access to the patients face
- Contoured and comfortable to wear
- Adjustable straps to allow a secure fit
- Elongated mask shape to suit all adult face shapes
- Kink resistant star lumen oxygen tubing
- Variety of configurations to meet all clinical requirements, optional hydrophobic filter and 3m CO₂ sample line

PRODUCT DATA

- Oxygen tubing length: 3m
- Oxygen tubing type: Star lumen
- CO₂ extension line outlet length: 10cm
- ABS Filter: 0.2 micron
- CO₂ sample line length: 3m
- Materials: PVC Mask and tubing
- DEHP NO = Not detected (Result less than the Method Detection Limit EN 14372)
- Not Made with Natural Rubber Latex
- ARTG Number: 308751
- Shelf life: 5 Years

STANDARDS

- ISO 18562-1:2017 Biocompatibility evaluation of breathing gas pathways in healthcare applications — Part 1: Evaluation and testing within a risk management process
- IEC 62366-1:2015/Amd 1:2020 Medical devices — Part 1: Application of usability engineering to medical devices — Amendment 1
- ISO 10993-1:2009 - Biological evaluation of medical devices

PRODUCT DIAGRAM

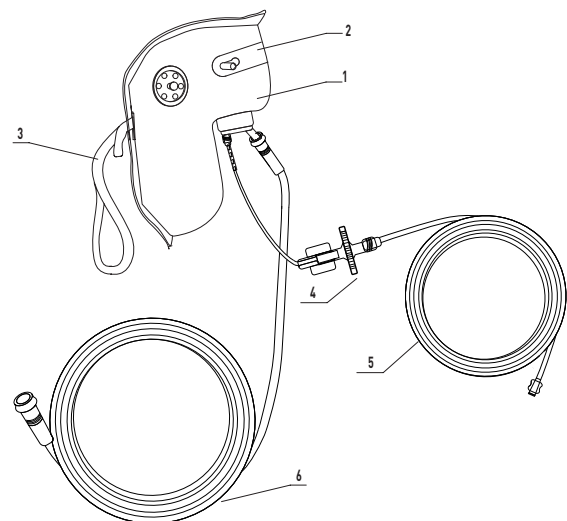

ITEM	DESCRIPTION
1	Mask
2	Nose Clip
3	Elastic Strap
4	Filter
5	3m CO ₂ Sample Line
6	3m Oxygen Tube

Capnography Cut-Down Masks

Cut-Down Capnography Masks				
RE-ORDER	DESCRIPTION		SIZE	CARTON/QTY
AN068000NS	Capnography Cut-Down Mask		Adult	50
AN068001NS	Capnography Cut-Down Mask with 3m CO2 Sample Line		Adult	50
AN068002NS	Capnography Cut-Down Mask with filter		Adult	50
AN068003NS	Capnography Cut-Down Mask with filter and 3m CO2 Sample Line		Adult	50

* All masks include 10cm Extension CO2 Sample Line Outlet, 3m Clear Oxygen Tubing